

Expansion and Contraction Values

Length (Meters) \ Installation Temperature (°C)										
	1	2.44	2.8	3	3.66	3.9	4	4.88	5.4	
10	1.2	3.9	4.5	4.8	5.9	6.2	6.4	7.8	8.6	Gap
15	1.4	3.4	3.9	4.2	5.1	5.5	5.6	6.8	7.6	
20	1.2	2.9	3.4	3.6	4.4	4.7	4.8	5.9	6.5	
25	1	2.4	2.8	3	3.7	3.9	4	4.9	5.4	
30	0.8	2	2.2	2.4	2.9	3.1	3.2	3.9	4.3	
35	0.6	1.5	1.7	1.8	2.2	2.3	2.4	2.9	3.2	
40	0.4	1	1.1	1.2	1.5	1.6	1.6	2	2.2	
45	0.2	0.5	0.6	0.6	0.7	0.8	0.8	1	1.1	

Maximum Decking Spans on Centre-to-Centre

Profile	Dimensions	Residential Span	Commercial Span
UH02, Grooved Hollow Board	138 x 22.5 mm	350 mm	N/A
US07, Solid Square Edge Board	138 x 22.5 mm	400 mm	350 mm
US49, Grooved Solid Board	138 x 25 mm	450 mm	400 mm
US48, Solid Square Edge Board	138 x 25 mm	450 mm	400 mm

**** Please be aware that board widths may vary + or – 2mm.**

Joist Spanning on Centre-to-Centre with Angled Decking Installations

Degree of Angle	Spacing
90	Refer to the above tables
60	50 mm less than the stated above tables
45	100 mm less than the stated above tables
30	½ the distance stated in the above tables

Recommended Decking Layouts

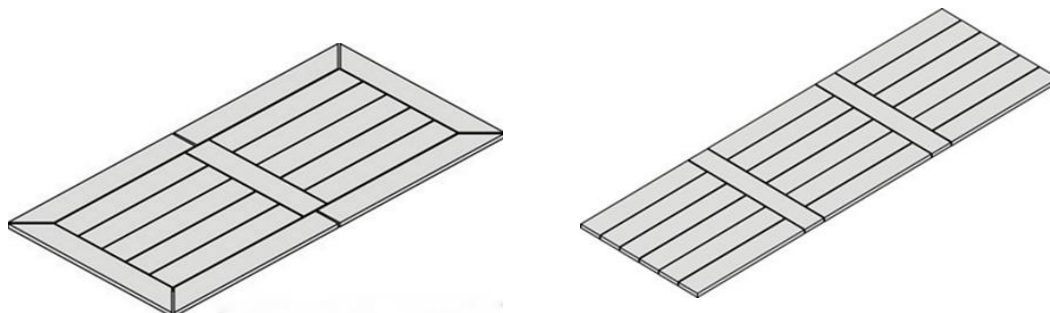

DISTRIBUTED BY:  **Urban Direct Wholesale**
Sourcing Better Products

NEWTECHWOOD TC-10 CLIP INSTALLATION GUIDE



Ultrashield Clip Installation - Parts



TC-10 Hidden Fasteners



K37 Start/End Fastener



MG3 Clip



Solid Grooved – 138 x 25 mm



Fascia – 138 x 15 mm



Solid – 138 x 25 mm



Hollow Grooved – 138 x 22.5 mm

Installing Starting Clips & the First Board

1.

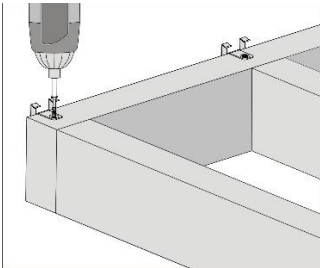

Install the K37/MG3 starting clips – centred at the edge of each.

2.

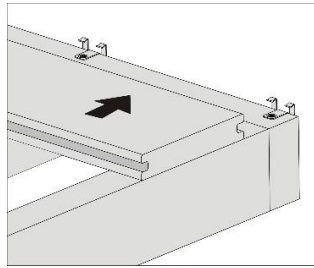

Take the grooved board and push it into the starting clips.

2b.

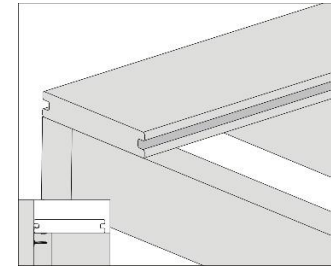

First board installed.

Installing Hidden Fasteners

3.

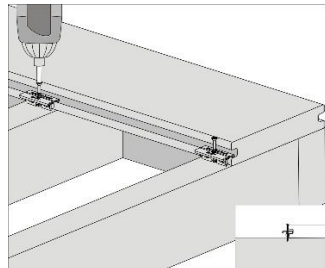

Insert the **TC-10** hidden fastener clips into the grooved edge of the deck board (all clips need to be installed in the same direction, i.e. the teeth of the clip are facing the same way.)

4.

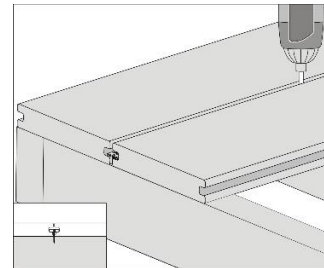

Ensure the screw hole is aligned with the centre of each joist.

5.

Screw half way down – **DO NOT fully tighten the hidden fastener clips.**

6.

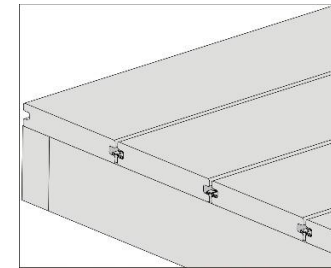

Slide the second board into the hidden fastener. Finish screwing down the hidden fastener clips on the previous board. **DO NOT fully tighten the hidden fastener clips – the screw should be flush with the top of the fastener when fixed properly.**

Repeat steps 3-6 to finish installing the remaining boards, then:

7.

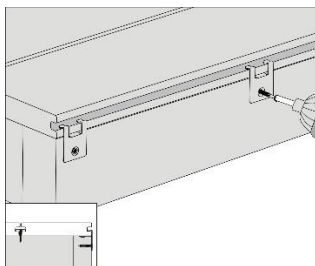

For the final board use the start/end fasteners and screw the fastener in from the side to fix the last board in place.

8.

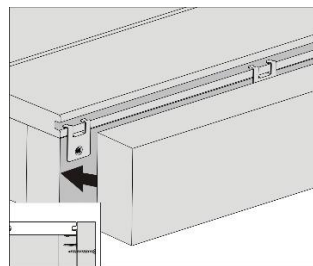

Finally, install the fascia using two composite screws – every 300mm centre to centre. **Fascia boards always need to be pre-drilled and countersunk before they can be face fixed.**

All fasteners should be on their own independent joists, when two boards ends meet each other there must be a sister joist. The end of each board must sit on its own joist.

Sister Joist

DISTRIBUTED BY:

