

NewTechWood



# NewTechWood Cobra T-Clip Installation Guide

## Expansion and Contraction Values

Length (Meters) \ Installation Temperature (°C)										
	1	2.44	2.8	3	3.66	3.9	4	4.88	5.4	
10	1.2	3.9	4.5	4.8	5.9	6.2	6.4	7.8	8.6	Gap
15	1.4	3.4	3.9	4.2	5.1	5.5	5.6	6.8	7.6	
20	1.2	2.9	3.4	3.6	4.4	4.7	4.8	5.9	6.5	
25	1	2.4	2.8	3	3.7	3.9	4	4.9	5.4	
30	0.8	2	2.2	2.4	2.9	3.1	3.2	3.9	4.3	
35	0.6	1.5	1.7	1.8	2.2	2.3	2.4	2.9	3.2	
40	0.4	1	1.1	1.2	1.5	1.6	1.6	2	2.2	
45	0.2	0.5	0.6	0.6	0.7	0.8	0.8	1	1.1	

Note: We recommend acclimatizing the boards at least 2 days prior to installation to avoid potential unwanted contraction issues that may arise during or after installation. When acclimatizing the boards, it is important to lay them on an even and flat surface to avoid the possibility, in some environments, of the boards warping to the shape of the terrain.

Maximum Decking Span on Centres					
Profile Code	Specifications	Residential Span	Commercial Span	Min Ground Clearance	Min Ground Clearance over Concrete
US49 / US63	138mm x 25mm	450mm	350mm	100mm	40mm
US54	210mm x 23mm	400mm	300mm	100mm	40mm
US33 / US07	138mm x 23mm	400mm	300mm	100mm	40mm
US92 / US93	138mm x 29mm	450mm	n/a	100mm	40mm

\*\* Please be aware that board widths may vary + or – 2mm.

Joist Spanning on Centre-to-Centre with Angled Decking Installations	
Degree of Angle	Spacing
90	Refer to the above tables
60	50 mm less than the stated above tables
45	100 mm less than the stated above tables
30	½ the distance stated in the above tables

## Recommended Decking Layouts

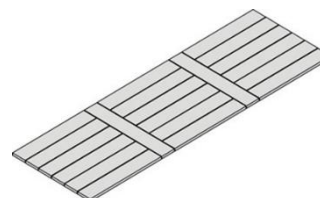
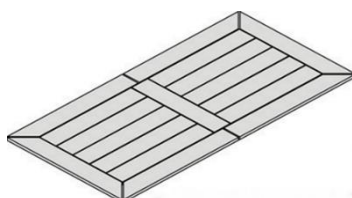

# NewTechWood Cobra T-Clip Installation Guide

## NewTechWood Clip Installation - Parts



Cobra T-Clip



K37 Start/End Fastener



MG3 Clip



Solid Grooved  
138 x 25 mm



Fascia  
138 x 15 mm



Solid  
138 x 25 mm



Scalloped - Grooved  
138 x 29 mm

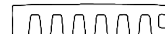

Scalloped - Grooved  
Edge Board  
138 x 29 mm

### PLEASE NOTE:

This Installation Guide does NOT replace the full NewTechWood Decking Installation Guide, downloadable from <https://newtechwood.com.au/installation-guides/>

## Installing Starting Clips & the First Board

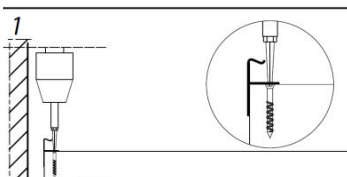

Install the K37/MG3 starting clips – centred at the edge of each.

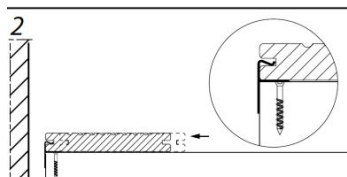

Take the grooved board and push it into the starting clips.

**Note:** Our Metal Fix screws are suitable for steel joists of up to 2mm in thickness. If thicker than 2mm, then you must pre-drill each hole.

## Installing Hidden Fasteners

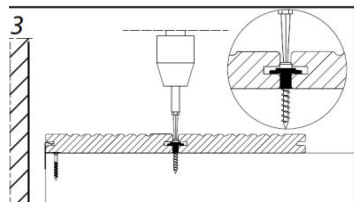

Insert the Cobra T-Clip into the grooved edge of the deck board. Slide the second board into the hidden fastener. Screw down the hidden fastener.

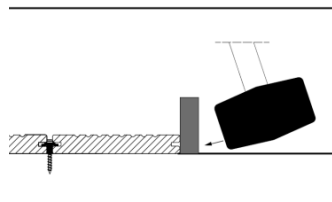

Tighten the second board with a rubber mallet to ensure a consistent gap of 6mm max between the two boards.

## Repeat steps 3-4 to finish installing the remaining boards, then:

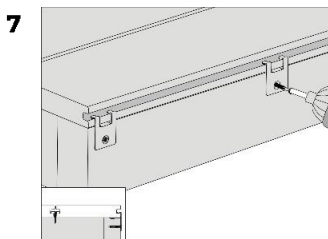

For the final board use the start/end fasteners and screw the fastener in from the side to fix the last board in place.

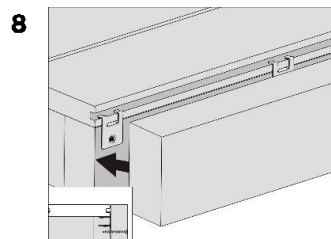

Finally, install the fascia using two composite screws – every 400mm centre to centre. **Fascia boards always need to be pre-drilled and countersunk before they can be face fixed.**

**All fasteners should be on their own independent joists**, when two boards ends meet each other there must be a sister joist. The end of each board must sit on its own joist.

